

- ☐ Mitre 10 MEGA Petone 25 Bouverie Street, Petone PO Box 44003, Lower Hutt. Telephone: 04 569 8311, Fax: 04 569 8940 **Denton 24319**
- ☐ Mitre 10 MEGA Upper Hutt 9 Park Street, Upper Hutt PO Box 44003, Lower Hutt. Telephone: 04 527 2227, Fax: 04 528 2550
- ☐ Mitre 10 MEGA Porirua 3-5 Semple Street, Porirua PO Box 44003, Lower Hutt. Telephone: 04 233 8009, Fax: 04 233 9496

Builder: Dr Ross Denton

SCHEDULE OF MATERIAL

for

PLUNKET ROOMS

at

6 LINDEN AVENUE

TAWA

4-Aug-14

(This document is to provide a guideline only and not to form part of a Contract)

NOTES

1. An Estimate of materials. This is an **ESTIMATE ONLY**. While Mega Petone has made reasonable efforts to the accuracy of this estimate, customers are advised that construction and building techniques do vary considerably and on site circumstances cannot be anticipated by Mega Petone

2. Estimated prices for materials do not include G.S.T, which will be added when invoicing

3. No responsibility is held for any error in calculation volume, takeoff or estimation by Mega Petone

4. If only part of this Estimate is going to be used, we have the right to amend any of the discounts that apply.

5. Cartage **WILL** be charged at

Small Truck From - \$47.82

Nees HIAB From - \$100 Courtesy Trailer - No Charge

6. All prices valid for 30 days, then are subject increased costs and availability

SUMMARY

STAGE ONE - TO FLOOR	Ground Floor Framing & Flooring	\$18,661.51
	Entry Decking.....	\$2,663.87
	Meeting Room Decking.....	\$4,009.72
STAGE TWO - FRAMING See Below for Framing Option	Wall Framing Accessories & Bracing	\$1,133.70
	Roof Framing.....	\$3,415.00
STAGE THREE - CLOSED IN	Exterior Sheathing and Trim	\$8,984.97
STAGE FOUR - FINISHING	Interior Lining and Trim	\$8,538.61
	Doors and Frames	\$3,420.90
Sub Total		\$50,828.27
GST 15.0%		\$7,624.24
Total		\$58,452.51

ALTERNATIVES or OPTIONS*(Not Included in Summary)*

Boxing Option.....	\$190.28
Wall Framing Option in Lieu of Pre Nail	\$5,012.08
Roofing	\$7,937.25
Spouting.....	\$1,265.21
Hardware.....	\$431.63
Sundry Items	\$349.97
Plumbing Items.....	\$286.80
Bathroom Items ...	

Name Dr Ross Denton
Address

Phone

File No. **24319**
Branch MegaStore
Takeoff Paul B

NOTE WELL

This Document should NOT be Used for CONTRACTURAL Purposes

No Specification Provided

No Construction Details Provided

Details Assumed to Complete This Document

This Document is Provided as a Guide for Material Rates Only

Contractor Shall Verify Suitability of All Selected Products especially DURABILITY Compliancy - BRANZ Bulletin 32:

The True Extent and Nature of Work Can Only be Ascertained By On-Site Inspection
Preparation of this document was from Drawings Only - The Contractor MUST Check & Confirm ALL on Site

Hurricane Fence On Steel Poles By Others
No Specification Provided

STAGE ONE - TO FLOOR

FOUNDATION AND FLOOR

Boxing - Alternative -Not Included in Summary Total

Note: Formwork Measured To External Footing Line Only

To Stair Pads	616007	100x25 Rad Boxing UT RS No3 LM	12.5 M.	0.87	10.90
Boxing Framing & Braces	614207	Radiata No 2 H1 P/G 100x50	18.8 M.	2.83	53.12
Pegs to Profiles Etc	616055	50x50 Rad Boxing UT RS No3 LM	44.0 M.	1.06	46.56
Profile	616013	150x25 Rad Boxing UT RS No3 LM	44.0 M.	1.49	65.49

Miscellaneous Fixings

Framing Fixings	190799	Nail Bright Flat Hd 60mmx2.80mm 500G	1.0 Pkt	1.94	1.94
Framing Fixings	190924	Nail Bright Flat Hd 100mmx4.00mm 500G	1.0 Pkt	1.94	1.94
Framing Fixings	190922	Nail Bright Flat Hd 75mmx3.15mm 500G	1.0 Pkt	1.94	1.94
Marking	360357	Spraykote Upside Down Dazzle Orange	1.0 Ea.	8.39	8.39

End of Section

\$190.28

SUB FLOOR FRAMING & FLOORING*Contractor to Timber Treatment Requirement***Sub Floor Framing***Driven Foundation Poles**Contractor MUST Check Pole Length On-Site**3m Long Poles Assumed - Contractor To Verify*

Anchor Poles	636226	Pole Rad 150 Sed H5 3.0M	21.0 Ea	34.42	722.80
Ordinary Poles	636226	Pole Rad 150 Sed H5 3.0M	66.0 Ea	34.42	2271.65
Pile Connectors	432100	Pile Bearer 12Kn Severe Pryda	21.0 set	31.77	667.08
Bearer To Poles	901320	Wire Dog Lefthand Stainless Steel	66.0 Ea	1.34	88.52
Bearer To Poles	901321	Wire Dog Righthand Stainless Steel	66.0 Ea	1.34	88.52
Joists To Bearers	170355	Ceiling Tie CT160LH Stainless Lumberlok	132.0 Ea	1.08	142.87
Joists To Bearers	170356	Ceiling Tie CT160RH Stainless Lumberlok	132.0 Ea	1.08	142.87
Dpc Packer Etc	428118	Dampcourse Dpc 2Ply 100mmx20M Per Roll	1.0 Roll	10.09	10.09
Bearers	612279	150x100 Rad N1 H4 MG LM	123.4 M.	13.31	1642.96

Floor Framing & Flooring*H3.2 Floor Joists Noted On Plans*

Floor Joist at 450mm crs	610705	150x50 Rad MSG8 H3.2 KD MG LM	470.3 M.	6.28	2953.07
Perimeter Joist	610705	150x50 Rad MSG8 H3.2 KD MG LM	40.3 M.	6.28	253.05
Mid Span Blocking	610705	150x50 Rad MSG8 H3.2 KD MG LM	92.7 M.	6.28	582.07
Interior Wall Blocking	610705	150x50 Rad MSG8 H3.2 KD MG LM	56.9 M.	6.28	357.28
Floor Nogging	610703	100x50 Rad MSG8/VSG H3.2 KD MG LM	69.5 M.	4.13	286.89
Snugfloor Insulation	107339	Snugfloor 450 R2.6 1220x430x100mm 7.9M2	23.0 Bale	78.96	1815.97

21mm Ecoply Flooring Noted On Plans

21mm Ecoply Flooring		IPL Tuff Ply Flooring 2400x1200x21mm Un Treat	66.0 Sht	91.66	6049.56
Fixings - up to 15mm	432401	Nail Senco 65x2.8mm Ring Galv 2000Pk	2.0 Box	51.66	103.32

Fixings

Framing Fixings	190935	Nail Bright Flat HD 100mmx4.00mm 5Kg	6.0 Pkt	14.46	86.76
-----------------	--------	--------------------------------------	---------	-------	-------

Baseboard*140x19mm H3.2 Baseboards Noted On Plans*

Base Boards	901759	150x25 Radiata H3 PG Merch	131.1 M.	2.35	307.94
Fixings	191221	Nail SS Flat HD 60mmx3.15mm 2Kg	2.0 Pkt	42.06	84.12

Access Door

Hinge	209315	Hinge T Light 100mm TH100L	2.0 Ea	1.21	2.42
Hasp & Staple	207089	Hasp & Staple 115mm	1.0 Ea	1.71	1.71

End of Section**\$18,661.51**

ENTRY DECKING*Driven Foundation Poles**Contractor MUST Check Pole Length On-Site**3m Long Poles Assumed - Contractor To Verify*

Ordinary Poles	636226	Pole Rad 150 Sed H5 3.0M	21.0 Ea	34.42	722.80
Bearer To Poles	901320	Wire Dog Lefthand Stainless Steel	21.0 Ea	1.34	28.17
Bearer To Poles	901321	Wire Dog Righthand Stainless Steel	21.0 Ea	1.34	28.17
Joists To Bearers	170355	Ceiling Tie CT160LH Stainless Lumberlok	42.0 Ea	1.08	45.46
Joists To Bearers	170356	Ceiling Tie CT160RH Stainless Lumberlok	42.0 Ea	1.08	45.46

140x90 Bearers Assumed - Contractor To Verify

Bearers To Deck	612279	150x100 Rad N1 H4 MG LM	13.9 M.	13.31	185.07
Bearers To Ramp	612279	150x100 Rad N1 H4 MG LM	16.8 M.	13.31	223.68

Deck Joists

Deck Joist at 450mm crs	613604	150x50 Rad N1 H3.2 MG LM	29.7 M.	5.06	150.23
Boundary Joist	613604	150x50 Rad N1 H3.2 MG LM	13.4 M.	5.06	67.78
Blocking To Joists	613604	150x50 Rad N1 H3.2 MG LM	6.7 M.	5.06	33.89
Framing Fixings	190970	Nail Galv Flat HD 100mmx4.00mm 500G	3.0 Bag	2.47	7.41

Decking

Decking to Joists	635422	100x40 Rad Decking Gt Reg/Merch H3.2 LM	123.8 M.	2.27	280.71
Fixings to Decking	191185	Nail Galv Annular Grve Deck 75mm 500G	1.0 Pkt	2.99	2.99

Decking To Ramp

Decking to Joists	635422	100x40 Rad Decking Gt Reg/Merch H3.2 LM	96.8 M.	2.27	219.49
Fixings to Decking	191185	Nail Galv Annular Grve Deck 75mm 500G	1.0 Pkt	2.99	2.99

Steps

Concrete to 475x100 Stri.	931950	Concrete 17.5mPA 19mm Structural Per M3	0.1 m3	222.20	22.22
Shaped Stair Strings 400	613610	300x50 Rad N1 H3.2 MG LM	1.7 M.	11.63	19.77
Plates On Pad	613602	100x50 Rad N1 H3.2 MG LM	3.2 M.	3.43	10.98
Tread Bearers On Edge	613602	100x50 Rad N1 H3.2 MG LM	3.1 M.	3.43	10.63
Dpc To Plates	428118	Dampcourse Dpc 2Ply 100mmx20M Per Roll	1.0 Roll	10.09	10.09
Treads	635404	100x25 Rad Decking Gt Premium H3.2 LM	19.1 M.	2.15	41.09
Risers	965873	Radiata 100x25 H3 P&G Merch	3.2 M.	1.69	5.40
Risers	901759	150x25 Radiata H3 PG Merch	3.2 M.	2.35	7.52

Balustrade

Baluster Posts	612276	100x100 Rad N1 H4 MG LM	13.2 M.	8.26	108.98
Bolt to Baluster	975623	Bolt Eng M12x160 S/S T316/Nut	20.0 Ea	2.65	52.94
Washer to Last	198713	Washer Square SS316 M12	20.0 Ea	3.40	68.00

MSG8 Framing Assumed - Contractor To Verify

Top Rail	610703	100x50 Rad MSG8/VSG H3.2 KD MG LM	12.2 M.	4.13	50.36
Balusters @ 140 crs	613801	50x50 Rad N1 H3.2 KD MG LM	79.2 M.	2.04	161.26
Bottom Rail	610703	100x50 Rad MSG8/VSG H3.2 KD MG LM	12.2 M.	4.13	50.36

MS Handrail Brackets By Others

40mm Dia H3 Handrail		Dowel H3 Rad 40mm Clr Per M	12.2 M.		
----------------------	--	-----------------------------	---------	--	--

End of Section**\$2,663.87****MEETING ROOM DECKING***Driven Foundation Poles**Contractor MUST Check Pole Length On-Site**3m Long Poles Assumed - Contractor To Verify*

Ordinary Poles	636226	Pole Rad 150 Sed H5 3.0M	36.0 Ea	34.42	1239.08
Bearer To Poles	901320	Wire Dog Lefthand Stainless Steel	36.0 Ea	1.34	48.28
Bearer To Poles	901321	Wire Dog Righthand Stainless Steel	36.0 Ea	1.34	48.28
Joists To Bearers	170355	Ceiling Tie CT160LH Stainless Lumberlok	72.0 Ea	1.08	77.93
Joists To Bearers	170356	Ceiling Tie CT160RH Stainless Lumberlok	72.0 Ea	1.08	77.93

140x90 Bearers Assumed - Contractor To Verify

Bearers To Deck	612279	150x100 Rad N1 H4 MG LM	15.2 M.	13.31	202.37
Bearers To Ramp Landin	612279	150x100 Rad N1 H4 MG LM	6.6 M.	13.31	87.87
Bearers To Ramps	612279	150x100 Rad N1 H4 MG LM	16.8 M.	13.31	223.68

Deck Joists

Deck Joist at 450mm crs	613604	150x50 Rad N1 H3.2 MG LM	43.9 M.	5.06	222.05
Boundary Joist	613604	150x50 Rad N1 H3.2 MG LM	12.3 M.	5.06	62.22
Blocking To Joists	613604	150x50 Rad N1 H3.2 MG LM	11.0 M.	5.06	55.64

Fixings

Framing Fixings	190970	Nail Galv Flat HD 100mmx4.00mm 500G	4.0 Bag	2.47	9.88
-----------------	--------	-------------------------------------	---------	------	------

Decking

Decking to Joists	635422	100x40 Rad Decking Gt Reg/Merch H3.2 LM	163.1 M.	2.27	369.82
Fixings to Decking	191185	Nail Galv Annular Grve Deck 75mm 500G	1.0 Pkt	2.99	2.99

Decking To Ramp

Decking to Joists	635422	100x40 Rad Decking Gt Reg/Merch H3.2 LM	128.3 M.	2.27	290.92
Fixings to Decking	191185	Nail Galv Annular Grve Deck 75mm 500G	1.0 Pkt	2.99	2.99

Steps

Concrete to 475x100 Str.	931950	Concrete 17.5mPA 19mm Structural Per M3	0.1 m3	222.20	22.22
Shaped Stair Strings 400	613610	300x50 Rad N1 H3.2 MG LM	1.7 M.	11.63	19.77
Plates On Pad	613602	100x50 Rad N1 H3.2 MG LM	3.2 M.	3.43	10.98
Tread Bearers On Edge	613602	100x50 Rad N1 H3.2 MG LM	3.1 M.	3.43	10.63
Dpc To Plates	428118	Dampcourse Dpc 2Ply 100mmx20M Per Roll	1.0 Roll	10.09	10.09
Treads	635404	100x25 Rad Decking Gt Premium H3.2 LM	22.5 M.	2.15	48.40
Risers	965873	Radiata 100x25 H3 P&G Merch	3.7 M.	1.69	6.24
Risers	901759	150x25 Radiata H3 PG Merch	3.7 M.	2.35	8.69

Balustrade

Baluster Posts	612276	100x100 Rad N1 H4 MG LM	23.8 M.	8.26	196.49
Bolt to Baluster	975623	Bolt Eng M12x160 S/S T316/Nut	36.0 Ea	2.65	95.30
Washer to Last	198713	Washer Square SS316 M12	36.0 Ea	3.40	122.40

MSG8 Framing Assumed - Contractor To Verify

Top Rail	610703	100x50 Rad MSG8/VSG H3.2 KD MG LM	20.4 M.	4.13	84.21
Balusters @ 140 crs	613801	50x50 Rad N1 H3.2 KD MG LM	131.7 M.	2.04	268.15
Bottom Rail	610703	100x50 Rad MSG8/VSG H3.2 KD MG LM	20.4 M.	4.13	84.21

MS Handrail Brackets By Others

40mm Dia H3 Handrail		Dowel H3 Rad 40mm Clr Per M	23.7 M.		
----------------------	--	-----------------------------	---------	--	--

End of Section**\$4,009.72**

STAGE TWO - FRAMING**PRENAIL FRAMING - See Attached Sheet**

By Fabricator

WALL FRAMING - Alternative -Not Included in Summary Total

Contractor to Timber Treatment Requirement

Top & Bottom Plates	610213	100x50 Rad MSG8/VSG8 H1.2 KD MG LM	230.0 M.	3.55	815.70
Studs @ 400 ctrs (Ext)	610213	100x50 Rad MSG8/VSG8 H1.2 KD MG LM	385.4 M.	3.55	1366.84
Studs @ 600 ctrs (Int)	610213	100x50 Rad MSG8/VSG8 H1.2 KD MG LM	328.1 M.	3.55	1163.62
Dwangs @ 800 ctrs	610213	100x50 Rad MSG8/VSG8 H1.2 KD MG LM	192.8 M.	3.55	683.77
Sill Trimmers	610213	100x50 Rad MSG8/VSG8 H1.2 KD MG LM	22.3 M.	3.55	79.09
150x45 Hyspan Lintels		Hyspan 150 x 45mm Un Treated	10.8 M.	17.30	186.84
150x63 Hyspan Lintels		Hyspan 150 x 63mm Un Treated	22.8 M.	24.25	552.90
Miscellaneous Fixings					
Framing Fixings	190939	Nail Bright Flat Hd 100mmx4.00mm 15Kg	3.0 Box	44.80	134.40
Framing Fixings	190933	Nail Bright Flat HD 75mmx3.15mm 5Kg	2.0 Pkt	14.46	28.92

End of Section**\$5,012.08****WALL FRAMING SUNDRIES**

To Bottom Plate	428118	Dampcourse Dpc 2Ply 100mmx20M Per Roll	5.0 Roll	10.09	50.47
Int Plate Fixing	190808	Pin Drive 75mm Std Shank Box100	1.0 Box	36.33	36.33
Fixing Charge	190901	Charges Yellow Ramset 22 Box100	1.0 Box	15.34	15.34
Washer	194089	Disc 16mm 14G Ramset Box100	1.0 Box	5.67	5.67
Nail Plates To Partition Jc	432244	Nailplate MP6R10 76x190mm	60.0 Ea	0.88	52.94
Lintel Fixings	170328	Lumberlock Multibrace 53mm Wide x 10M	3.0 Coil	20.59	61.77
Handibrac	434379	Gib Handibrac Pkt2	42.0 Ea	7.55	317.23
Handibrac & Bolt	165762	Gib Handibrac Screw Bolt 1Pair	42.0 Ea	12.19	511.92
Sheet Brace	432302	Strap Sheet Brace 400mm SBS400	84.0 Ea	0.98	82.03

End of Section**\$1,133.70**

TRUSSES AND/OR PRECUT RAFTERS - See Attached Sheet*By Fabricator***ROOF FRAMING***Contractor to Timber Treatment Requirement***Roof Framing**

Purlins @ 900 crs	614204	75x50 Rad N2 H1.2 MG LM	370.3 M.	1.86	688.94
Purlin Screw	179842	Purlin Screw (Blue Screw) 250Pk	4.0 Jar	36.39	145.57
strap bracing	432119	Strapbrace 30M With Tensioners	1.0 Coil	49.99	49.99

Miscellaneous Fixings

Framing Fixings	190935	Nail Bright Flat HD 100mmx4.00mm 5Kg	3.0 Pkt	14.46	43.38
-----------------	--------	--------------------------------------	---------	-------	-------

Fascia Barge - Contractor to Verify Size & Profile

Fascia	626861	150x25 Fascia Rad FJ H3.1 PP Groov	70.7 M.	5.58	394.61
--------	--------	------------------------------------	---------	------	--------

Soffit Framing and Lining - Contractor to Verify

Soffit Ribbon	620231	75x40 Rad Merch H1.2 FJ LM	65.6 M.	2.21	144.93
Soffit Sprokets	620231	75x40 Rad Merch H1.2 FJ LM	54.7 M.	2.21	120.85
To Soffits & Eaves	433119	Hardisoffit 2400x450x4.5mm	28.0 Sht	10.86	303.97
Fixing to Soffit	107119	Nail Fibre Cement Galv 40mmx2.8mm 2Kg	1.0 Pkt	13.51	13.51
To Soffits & Eaves	433818	Hardisoffit Jointer 450mm x 5.00mm Pvc	26.0 No	0.84	21.72

Ceiling Framing

Truss Plate	610201	150x40 Rad MSG8 H1.2 KD MG LM	122.4 M.	4.53	555.07
Ceiling Strapping	620231	75x40 Rad Merch H1.2 FJ LM	391.7 M.	2.21	865.39
Fixing to Strapping	263984	Nail Gun Nails 75x3.06 Paslode 3000Pk	1.0 Ea	67.09	67.09

End of Section**\$3,415.00**

ROOFING - Alternative -Not Included in Summary Total

Estimate ONLY - Contractor MUST Check On Site for Roof Areas & Measurements

Self Supporting Paper Measured - Contractor to Confirm

Netting	234117	Wire Netting Hex	Galv 75mmx2000mmx50M	2.0 Roll	132.17	264.35
Netting	234116	Wire Netting Hex	Galv 75mmx900mmx50M	1.0 Roll	73.03	73.03
Staples	276641	Staple 140 Series	Galv 10mm 5000Pk	2.0 Box	18.80	37.60
Covertex 405 Paper		Covertex 405	1250mm x 40M	5.0 Roll	178.21	891.05

Contractor to Verify Profile Gauge Etc

Roofing		Corrugated ZR8/Endura Iron 762mm 0.55 PM	276.5 mtr	18.45	5101.43
Ridging	166989	Ridging ZR8/Endura .50 Se 130mm Leg PM	14.2 M.	15.80	224.37
Hip Flashings	166989	Ridging ZR8/Endura .50 Se 130mm Leg PM	35.9 M.	15.80	567.23
Valley Flashings	166996	Valley Flashing ZR8/Endura Standard PM	5.7 M.	15.69	89.46
Fixings	958085	Screw Tek 12x65 With Neo Box 500	6.0 Pkt	114.79	688.75

End of Section**\$7,937.25****SPOUTING - Alternative -Not Included in Summary Total**

Contractor to Verify Profile Style Etc

Gutter 5m length	161702	Spouting 5M Marley Classic MC1.5	12.0 Lgth	46.77	561.29
Gutter 3m length	161701	Spouting 3M Marley Classic MC1.3	3.0 Lgth	25.07	75.21
Gutter Bracket	161703	Bracket Marley Classic MC2	154.0 Each	1.68	257.95
Ext Angle	161707	External Angle Marley Classic MC6	5.0 Each	10.88	54.38
Int Angle	161708	Internal Angle Marley Classic MC7	1.0 Each	10.88	10.88
Gutter Union Clip	161706	Union Clip Marley Classic MC5	9.0 Each	2.10	18.90
80mm Exp Outlet Centre	161710	Outlet Exp 80 W/Backplate Marley Classic	5.0 Each	13.34	66.69
Welding Solvent	161743	Solvent Welding Marley 180Gm MCs	1.0 No.	11.64	11.64
Nail	161745	Nails Marley 150 Per Pkt MCn	1.0 No.	4.11	4.11
Round Downpipe	161736	Downpipe 80mmx3M Rp80	5.0 Lgth	24.95	124.74
Pipe Clip	161741	Pipe Clip 80mm RC 80	15.0 Each	1.76	26.44
Socket Bend	161737	Socket Bend 95Deg 80mm RB2 80	10.0 Each	5.30	53.00

End of Section**\$1,265.21**

STAGE THREE - CLOSED IN**EXTERIOR SHEATHING AND TRIM****Building Paper***Contractor to Verify Wind Zone & Suitability of Product*

To Corners	433645	James Hardie Corner Underflashing 3000mm	6.0 Lgth	7.79	46.72
Covertex 405 Paper		Covertex 405 1250mm x 40M	3.0 Roll	178.21	151.48
Strapping to Paper	200082	Builders Strap 19mmx300M Box	1.0 Roll	17.65	17.65
Staples	275039	Staples Rapid 140/12 Pk2000	1.0 Box	11.83	11.83
Flashing Kit to Openings	428430	Protecto Sill System Prof Builders Pack	1.0 Pkt	292.43	292.43
Flashing to Openings	428449	Protecto One Piece Sill Tape 20Mx150mm	5.0 Roll	103.53	517.66
Sill Over Flashing	104807	Tape Aluband 200Mmx25M	1.0 Roll	85.24	85.24

*Contractor to Verify R Value Complies for Exterior Cladding***Weatherboard Cladding***Contractor to Verify Profile Size Etc*

To Walls	626632	Weatherboard Bevel Back H3 PP FJ 200x25	850.9 M.	6.90	5867.30
Fixings	190668	Nail SS Rose HD 60mmx3.15mm 2Kg	4.0 Pkt	42.06	168.24
Scribers	637440	Rad Scriber 43x10 Clr H3 PP Rndm	63.6 M.	1.65	105.01
Corner Board	626401	Radiata FJ H3 D4S PP 75x25	13.8 M.	3.30	45.57
Corner Board	626404	100x25 Rad FJ PP H3 D4S LM	13.8 M.	4.34	59.85
Internal Bead	225247	Mld Rad Q18mm Quad H3 FJ PF Lm	2.8 M.	1.38	3.87

Exterior Trim

To Soffits & Eaves	950119	Rad Eave Mould 25x18 FJ H3 PP Per M	65.6 M.	2.06	135.02
Scribers To Meter Box	637440	Rad Scriber 43x10 Clr H3 PP Rndm	1.5 M.	1.65	2.48
Sealant	370661	No More Gaps 475G Cartridge	2.0 Ea	5.24	10.47

Timber Retaining Wall*Length Assumed - Contractor To Verify*

Retain Posts	636006	125x125 Rad House Pile H5 1.8M	24.0 Lgth	20.52	492.56
Footings	931950	Concrete 17.5mPA 19mm Structural Per M3	0.7 m3	222.20	154.12
Retain Planks	635829	200x50 Retaining Wall TG&V H4 MG RDM Rad	112.2 M.	5.58	626.24
Fixings	190986	Nail Galv Flat HD 100mmx4.00mm 5Kg	1.0 Pkt	20.82	20.82
Drain	161410	Drainflo 110mm x 15M Punched	2.0 Roll	57.18	114.36
Filter Sok	900314	Filter Sleeve 110mmx15M Pre-Loaded	2.0 Roll	28.02	56.05

End of Section**\$8,984.97**

STAGE FOUR - FINISHING**INTERIOR LININGS AND TRIM****Insulation**

To Ceilings	428025	Batts Pink R3.6 Ultra Ceiling 7.4M2	23.0 Bale	82.71	1902.34
To Walls	428178	Batts Pink R2.6 Ultra Wall 9.9M2 Insul	11.0 Bale	117.23	1289.54

Contractor to Verify R Value Complies for Exterior Cladding

Window Seal

Foam Seam	428439	Pef Backup Rod 12mmx50M Roll	2.0 Roll	22.53	45.06
Foamtak	371894	Sika Boom G Foam 750ml	1.0 Ea	17.13	17.13

Linings (Verify Braceline Measure)Ceiling Linings

To Ceilings - Glue & Scre	112344	Gib Brace Noise 13mm 2.4 x 1.2M	63.0 Sht	28.93	1822.46
Screw Fixing	195981	Screw Grabber Coll High Thd 6x32 1000Pk	4.0 Box	15.09	60.38
Adhesive To Gib Ceilings	370848	Gib All Bond 375MI Cartridge	10.0 Cart	5.91	59.06

Wall Linings

To Walls	112338	Gib Brace Noise 10mm 2.4x1.2M	37.0 Sht	24.03	889.18
Fixing to Gib Brace	195987	Screw Grabber High Th Braceline 7x32 250	9.0 Box	9.24	83.12
To Wet Wall Areas	433057	Gib Aqualine 10mm 2400mm	19.0 Sht	32.15	610.79
To Walls	433001	Gib Board Standard 10mm 2400mm	66.0 sht	16.94	1117.91
Fixing to Wall	195980	Screw Grabber Coll High Thd 6x25 1000Pk	5.0 Box	14.54	72.71
Fixing to Wall	112610	Gib Fix One 600MI Sausage	8.0 Cart	7.71	61.65
To Corners	433554	Gib Slim Angle Trims 90Deg 2.4M	3.0 Lgth	6.94	20.82

Interior Trim - Contractor to Verify Profile Size

Assumed - Contractor MUST Check On-Site

Std Skirting	225261	Mld Rad BA60x10 Bev Arch UT FJ Lm	156.6 M.	1.62	253.11
MDF Std Cornice	203119	Mld Mdf PP 30x18 Bev Cornice 5.4M	33.0 Lgth	6.91	227.93

Assumed NO Architraves - Contractor to Verify

Trim Fixing

Trim	190696	Panel Pin Zp 50mmx2.00mm 250G	1.0 Pkt	2.66	2.66
Trim	190695	Panel Pin Zp 40mmx1.60mm 250G	1.0 Pkt	2.75	2.75

End of Section

\$8,538.61

DOORS & FRAMES - Contractor Must Verify Type Style Frames Etc

Prehung Door Frame - 150x40mm PQ J6 Bev Rebated S/L Jambs

All Doors - Solid Core Int PQ UC Door

Sizes Are Generic - Check On-Site

Cavity Door & Frame

910mm Cavity slider c.with door	Solid Core Slider Cavity Hume	90mm Flat 910x19	2.0 Set	480.00	960.00
---------------------------------	-------------------------------	------------------	---------	--------	--------

Solid Core PQ Door U/C in S/Line Jamb

S/gle Hung Door in Frame	Solid Core Door 410-810 Single PQ On 150x40 F.	6.0 Set	410.15	2460.90
--------------------------	--	---------	--------	---------

End of Section**\$3,420.90****HARDWARE - Alternative -Not Included in Summary Total**

Assumed - Contractor MUST Check On-Site

Latchset	205289	Latch Passage Ply PB F10V Schlage	5.0 Pack	39.41	197.06
privacy latchset	205293	Privacy Set F40Nv Ply PB Schlage	1.0 Pack	45.88	45.88
Door Stop	212309	Door Stop Cushion White Sylon	6.0 No.	1.66	9.95
Sliding Door	206954	Lock Sliding Door Privcy PB 13578 Schlag	1.0 Ea	18.82	18.82
Sliding Door	902543	Schlage Lock Sliding Door Pass PB 46-100	1.0 Ea	49.38	49.38
Sliding Door Handles	208017	Flush Pull Sc 106-140 Miles Nelson	2.0 Ea	7.53	15.06
Toilet Holder	902734	Toilet Roll Spindle White 31304 Calvert	2.0 Ea	5.25	10.50
Towel Rail & Bracket	113703	Towel Rail 610mm Chrome Pastels Heirloom	2.0 Ea	42.49	84.98

End of Section**\$431.63****SUNDRY ITEMS - Alternative -Not Included in Summary Total**

Smoke Detector	114002	Smoke Alarm First Alert SA300	6.0 Ea.	10.71	64.24
Ceiling M/Hole	372302	Hatch Ceiling Access 635x635mm	1.0 Ea	83.36	83.36
Mirror - 900	333028	Mirror Vanity 900x900mm White Trendy	2.0 Ea	101.19	202.38

End of Section**\$349.97**

PLUMBING ITEMS - Alternative -Not Included in Summary Total

Basin Taps	158693	Basin Taps Trade-Line	2.0 Ea	57.28	114.55
WC Cistern Tap	930098	Cistern Tap And Hose Pack	2.0 Ea	26.25	52.50
Sink Taps	158692	Sink Faucet Trade-Line 15mm	1.0 Ea	93.75	93.75
Hose Taps	153474	Tap Hose Long Handle 15mm	2.0 Ea	13.00	26.00

End of Section**\$286.80****BATHROOM PACKAGE - Alternative -Not Included in Summary Total****End of Section****End Of Estimate**

FRAMES AND TRUSSES

- ☐ Mitre 10 MEGA Petone 25 Bouverie Street, Petone PO Box 44003, Lower Hutt. Telephone: 04 569 8311, Fax: 04 569 8040
- ☐ Mitre 10 MEGA Upper Hutt 9 Park Street, Upper Hutt PO Box 44003, Lower Hutt. Telephone: 04 527 2227, Fax: 04 528 2550
- ☐ Mitre 10 MEGA Porirua 3-5 Sample Street, Porirua PO Box 44003, Lower Hutt. Telephone: 04 233 8009, Fax: 04 233 9496

DATE: 31/07/2014
QUOTE NO: 4268
CUSTOMER: M10 Mega
SITE ADDRESS: 6 Linden Ave
SUBURB: Tawa



FRAMES

Post and panel braces are excluded. Single top plate.

Exterior Framing
Interior Framing BY OTHERS
Stud Centres
Bottom Plate Treatment
Stud Ht
Dwangs
Lintel Type

PRYDASPAN

Sizes and spacing as specified on plan.

Timber
Design Loads
Pryda Span size(s)
Centres

ROOF TRUSSES

Timber 90 x 45, MSG8, H1.2
Roof Pitch 15 Degrees
Centres 900
Overhang 400
Roof Material Corrugated Iron
Wind Area Very high
Includes Fly rafters, outriggers and fixings

PRECUT RAFTERS

Excludes all flat roof areas, furring and (H3) exposed unless noted of shown on plan,

Timber
Roof Pitch
Centres
Overhang
Roof Material
Wind Area
Excludes

Valley Boards, Collar ties, ceiling joists, underpurlins, struts, strutting beams and ridge beams
Outriggers, fly rafters, Std rafters and wire dogs.

Includes

TIMBER BEAMS

FLITCH BEAMS

PLEASE NOTE

Quotation includes Hiab delivery to site, subject to access.

Beams required to support roof are included in price.

If extra beams are required they will be charged separately.

Frames, trusses, Pryda span etc will be charged in the month they are manufactured.
Ownership does not pass until all invoices have been paid

This quote is valid for 30 days. Thank you for the opportunity to submit a price for the above job.

All Rectification work is to be notified to the Manufacturer within 24 hrs of receiving the goods. The Manufacturer will not be liable for any work or modifications done to the frames or trusses without our prior written consent.



EX G.S.T	\$ -
G.S.T	\$ -
TOTAL	\$ -

EX G.S.T	\$ -
G.S.T	\$ -
TOTAL	\$ -

EX G.S.T	\$ 5,135.91
G.S.T	\$ 770.39
TOTAL	\$ 5,906.30

EX G.S.T	\$ -
G.S.T	\$ -
TOTAL	\$ -

EX G.S.T	\$ -
G.S.T	\$ -
TOTAL	\$ -

EX G.S.T	\$ -
G.S.T	\$ -
TOTAL	\$ -

EX G.S.T	\$ 5,135.91
G.S.T	\$ 770.39
GRAND TOTAL	\$ 5,906.30



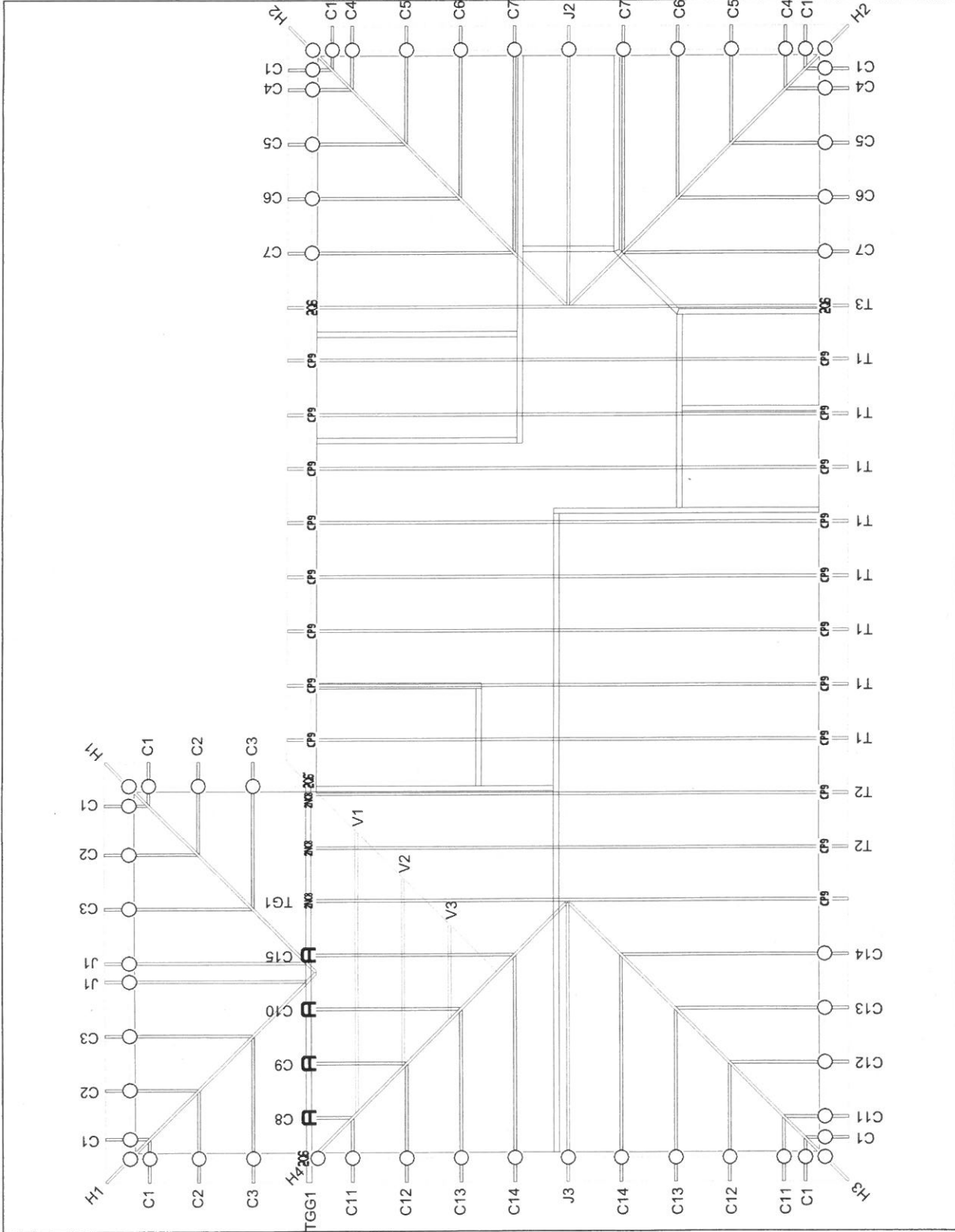

Job Ref: 4268
Scale: As Shown
Date: Thursday, 31 July 2014
Sheet:

Job Details:
Roofing: Corrugated iron
Pitch: 15.00 Deg.
Truss Spacing: 900
Design Wind Velocity: 50.00 m/s (Ult.)
Detailer: Glynn Champion

BUILDABLE LAYOUT

Customer: Mitre 10 Mega
Site Address: 6 Linden Ave
Tawa





DOORS



Hoults Doors Limited

Email: sales@houltsdoors.co.nz www.houltsdoors.co.nz
Phone: 4 5670 824 Fax: 4 5670 308
232 Cambridge Terrace, P O Box 35 053, Naenae

25/07/2014

Page 1

Quote Number
818601

Quotation

Mitre 10 Mega Petone

P O Box 44 003

Lower Hutt

JOB: 24319

LINDEN AVENUE

TAWA

Description	Qty.	Price	Units	Total
SOLID CORE UC MDF PQ DOORS 38mm THICK (UNLESS STATED OTHERWISE) PINE PQ JAMB FOR ARCH 110F 100mm SCP HINGES 2000 HIGH DOORS				
SINGLE SPECIAL PREHUNG 860 RH CLINIC2 860 LH STORE2 860 RH CLINIC1 860 RH STORE1 860 LH PINS	5		Each	
SINGLE SPECIAL PREHUNG 760 RH TOILET	1		Each	
CAVITY SLIDER UNIT PQ STD 90mm 1980 X 910 X 38 910 KITCHN 910 ACCESS	2 2		Each Each	
FREIGHT BEST COURIERS	1		Each	

INSTALLATION, PAINTING, HARDWARE INC KICKPLATES BY OTHERS

PRICES BASED ON INFORMATION SUPPLIED AT THE TIME OF QUOTATION. ALL RESPONSIBILITY
REMAINS WITH THE MAIN CONTRACTOR TO ENSURE ALL DOORS AND PRICES ARE CORRECT

All Cash Sales are to be paid for in full upon receipt of goods unless prior
arrangement has been made with Management or Trade Terms apply.

Goods remain the property of Hoults Doors Limited until paid in full.

All costs incurred in debt collection or recovery fees on overdue accounts
will be charged to the customer.

All permitted work undertaken is the responsibility of the owner.

This quote is valid for 30 days with conditions as above.

Please write your name and sign below as your acceptance of this quote.

Total Exc. GST \$3060.28
GST
Total Inc. GST

Name:

Signature:

Date Accepted: