

LINDEN AVENUE

ENTRY

new concrete curbing

6 Linden Avenue, Tawa  
LOT 20  
DP 15391

new paving

grass area

location of  
proposed  
building

new 800mm high  
retaining wall

1500

existing house

2000

existing fence

Retaining Wall Cross  
Section Detail  
scale 1:25

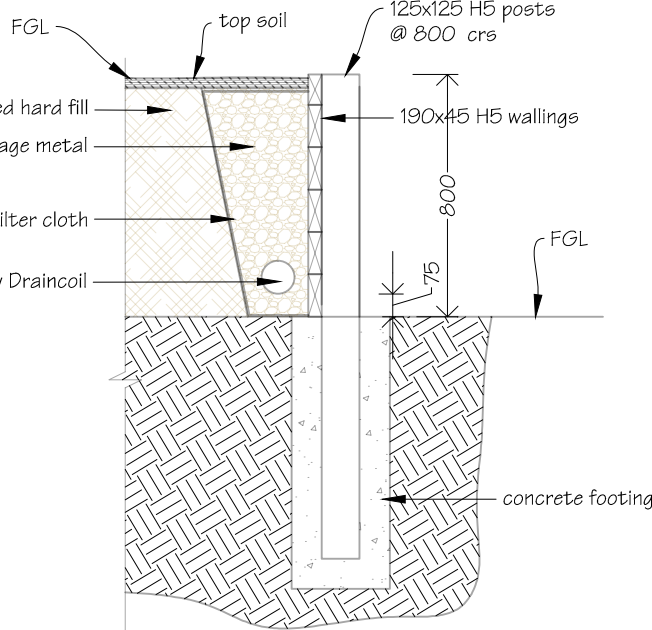

Ian Rattray Building Consultant  
P. O. Box 40-651  
Upper Hutt 5140

Phone (04) 526-7711  
Mobile 021-427-347  
Email ian@irbuild.co.nz  
Web www.irbuild.co.nz

Tawa Plunket Rooms  
Linden Avenue  
Tawa

PROJECT  
New Plunket Building

DRAWING TITLE  
Proposed Site Plan &  
Retaining Wall Detail

REVISIONS

No Date Description

Scale	1:200
Date	3/12/2014
Original sheet size	A3
Drawn	S. T.
Sheet No	i of i
Dwg Ref	i - A3

Pricing/Building Consent  
Drawings

Do not scale from drawings.  
Check all dimensions on site.